



20K SF +/- AVAILABLE FOR LEASE

70 SHAWMUT ROAD
CANTON, MA 02021

MANSARD  

Property Details



SPACE HIGHLIGHTS

- Zoning: LI Limited Industrial
- Uses By Right: Research, Lab, Warehouse/Distribution, Manufacturing
- Clear Ceiling Height 22'
- Parking Ratio: 2.06: 1,000 SF
- 20,000 SF, Flex/Warehouse/R&D

Lease Rate

NEGOTIABLE

OFFERING SUMMARY

Building Size:	49,920 SF
Available SF:	5,000 - 20,000 SF
Lot Size:	4.34 Acres
Year Built:	1984
Zoning:	LI- Limited Industrial
Market:	Boston

PROPERTY OVERVIEW

5,000, 10,000, 15,000 or 20,000 SF +/- of industrial flex space located in the Shawmut Industrial Park. This well-managed and maintained space is currently configured with approximately 50% office and 50% warehouse.

LOCATION OVERVIEW

Located in the heart of the Shawmut Industrial Park, providing, immediate access to I- 93 / I-95, minutes to University Avenue's new retail amenities. Less than 20 miles from Boston.

Floorplan

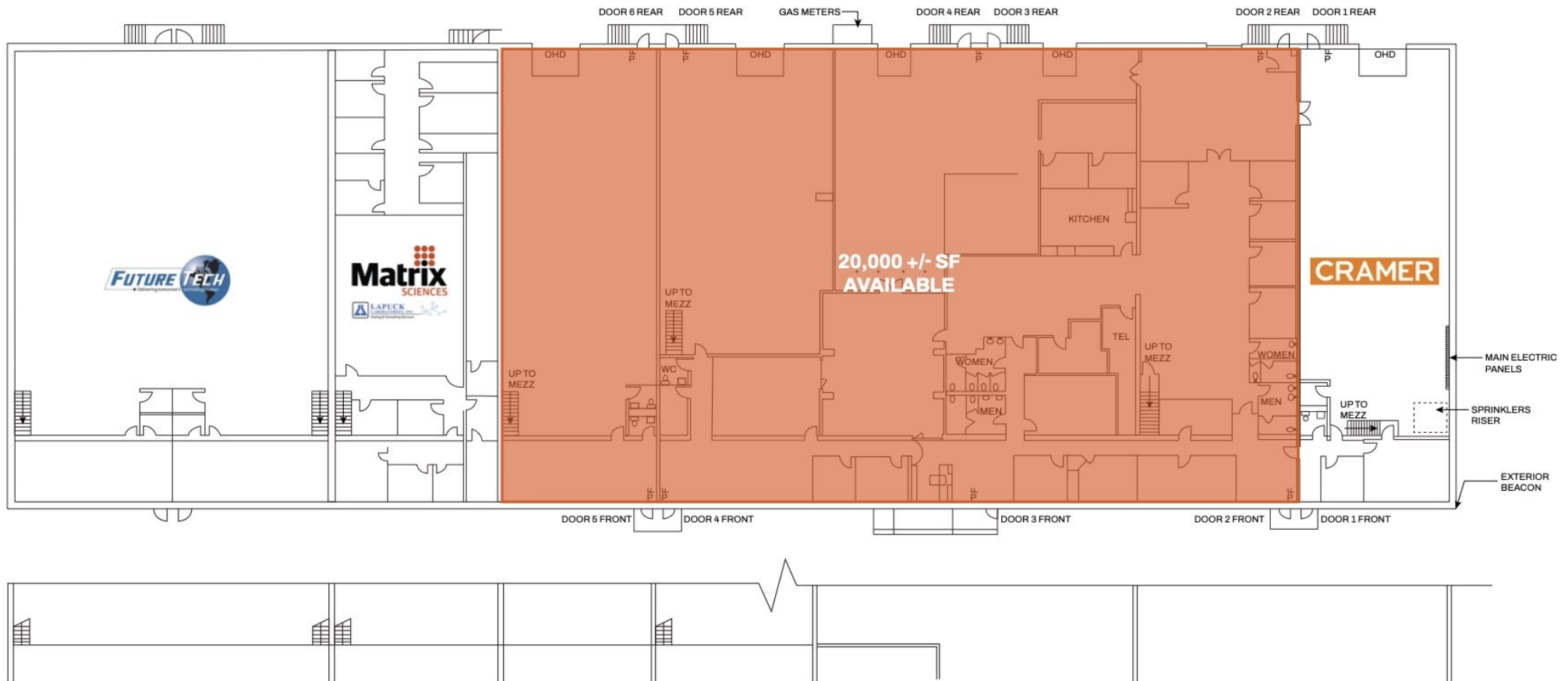

Additional Photos

