

1100 BENT CREEK BOULEVARD, MECHANICSBURG PA



PROPERTY DESCRIPTION

First floor office suite available for lease in a nice office building, located in the Bent Creek Business Park. This property offers on site storage, ample parking and on-site management. Convenient to I-81, Rt. 114 and Carlisle Pike.

PROPERTY HIGHLIGHTS

- +/-1,639 SF first floor suite
- Ample in common parking
- Many amenities - restaurant, major & local retailers, banking
- Available: April 2025

LAURA MARTIN, CCIM, CPM
O: 717.737.2422 x1001
laura.martin@svn.com
PA #RM419784

OFFERING SUMMARY

LEASE RATE:	\$18.95 SF/yr (MG +Janitorial)
AVAILABLE SF:	1,639 SF
BUILDING SIZE:	25,000 SF

DEMOGRAPHICS	1 MILE	5 MILES	10 MILES
TOTAL HOUSEHOLDS	389	26,263	93,961
TOTAL POPULATION	954	61,716	225,409
AVERAGE HH INCOME	\$94,161	\$88,621	\$75,141

FLOOR PLAN

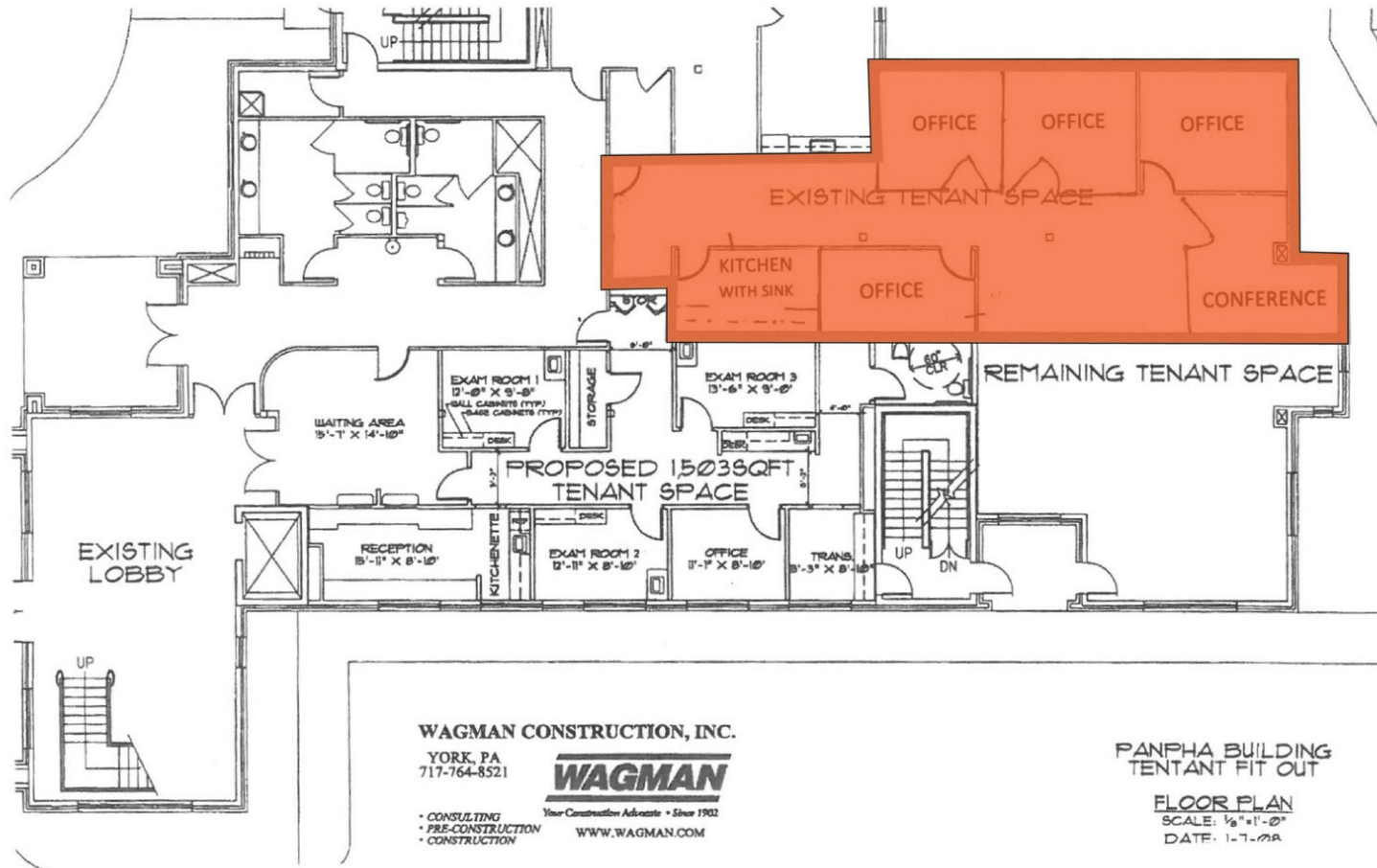

LAURA MARTIN, CCIM, CPM

O: 717.737.2422 x1001

laura.martin@svn.com

PA #RM419784

1100 BENT CREEK BOULEVARD | Mechanicsburg, PA 17050

SVN | LATUS 2

We obtained the information above from sources we believe to be reliable. However, we have not verified its accuracy and make no guarantee, warranty or representation about it. It is submitted subject to the possibility of errors, omissions, change of price, rental or other conditions, prior sale, lease or financing, or withdrawal without notice. We include projections, opinions, assumptions or estimates for example only, and they may not represent current or future performance of the property. You and your tax and legal advisors should conduct your own investigation of the property and transaction. All SVN offices are independently owned and operated.